

III. ANNUAL REPORTS

State Council of Hawaiian Congregational Churches

203rd 'Aha Iki

Message from David Popham, Conference Minister

Aloha mai kākou,

With just a few changes you will note this report is the same as the report to the 'Aha Pae'āina as a whole. This is due to the interweaving of aspirations and shared reality among us. I found it difficult not to speak of the same items at both gatherings. Please consider yourself as receiving an “advance copy” of the other.

Key Successes

1. Strengthening Congregational Vitality

- **New Ministry Initiatives:** Congregations such as Kawaiaha'o Church, Kapa'a UCC, Kaumakapili Church and others launched community-based ministries focused on food security, mental health, and youth engagement.
- **Leadership Development:** 22 pastors from five islands and four Associations explored “Renewing Hope” at the annual Pastoral Leaders Retreat through worship, small group discussions, and offsite adventures.
- **Digital Worship Expansion:** Approximately 80% of congregations now offer hybrid or online worship, increasing accessibility for kūpuna and diaspora members.

2. Justice and Witness

- **Environmental Stewardship:** The Conference promoted the “Ho'ōla Honua” initiative, supporting churches in adopting sustainable practices and advocating for climate justice.
- **Housing Advocacy:** Promoted local coalitions to support affordable housing legislation and hosted forums on homelessness and economic justice.
- **“A Call to Education and Action Regarding the Crisis in Gaza”** (resolution of the 2024 'Aha Pae'āina): Letters were sent to the President of the United States of America and to the Israeli Ambassador to the United States informing them of the passing of the resolution and seeking an end to the conflict.

3. Youth and Young Adult Engagement

- **Youth Event at the ‘Aha Pae‘āina:** 40 youth (grades 6-12) from five islands participated in the 2024 ‘Aha Youth Event, meeting sometimes unto themselves and sometimes with the larger gathering. This year 31 youth are participating in the ‘Aha Youth Event, which brings them to maximum capacity.

4. Maui Wildfire Recovery

- **Approximate dollars provided for recovery thus far:**
 - Maui Clergy Trauma Support: \$67,342 (primarily raised through grants)
 - Fire Victims Support: \$90,178 includes partnering with Po‘okela, Waiola, Wailuku Union, Maui Evangelical congregations, and Maui Voluntary Organizations Active in Disasters (VOAD) Council
 - These funds were provided during the immediate and the pressing needs phase of recovery.
- **Long-Term Phase:**
 - Conversation with Po‘okela Church about upgrades needed to turn facilities into a volunteer host site for Kula fire recovery.
 - Conversation with Waiola Church about temporary housing (5 yrs or so) on church residential lots for members who lost homes in fire.
 - Purchase of portable dome shelters.
- **Acknowledgments:**
 - Danny Tengan, HCUCC Disaster Response Coordinator
 - United Church of Christ Disaster Ministries
 - Brown Grant of the United Church Funds
 - Pacifica Synod, Evangelical Lutheran Church in America
 - Presbyterian Disaster Assistance, PC(USA)
 - Jonathan Roach and Ben Sheets, coordinators for Maui Clergy care

Challenges and Opportunities

1. Financial Sustainability

- **Local Church Revenue:**

Several congregations face declining tithes and offerings, prompting difficult conversations about building maintenance, pastoral staffing, and long-term viability.

- **Conference Budget:**

The Conference's operational budget continues tightening. The budget recovery plan revolves around stabilizing the unreserved endowment corpus by investment with the sale of the Craigside apartments coupled with shrinking the budget so as to reduce the endowment draw to 4.5%. We are in year five of this nine-year plan.

- **Faith Forward Capital Campaign:**

We remain in the quiet phase seeking larger donations. However, we are beginning to branch out to a more public stance with engaging congregations and the fuller membership of the HCUCC.

2. Congregational Life

- Many churches continue to experience aging membership without proportional growth in younger generations.
- Pastoral transitions increased as several long-serving ministers retired, creating gaps in leadership and continuity.

3. Cultural Tensions

- **Micronesian Churches**

Our Associations' Committees on Ministry strive to provide for church and ministerial standing while at the same time establishing standards of expectations. These standards tend to run into cultural misunderstandings and confusion for all parties involved. We continue to pledge to work together for clearer acknowledgments of each other's expectations.

- **Reconciliation Conversations:**

- At the August 2024 Council Meeting, a conversation was entered into about how best to help AHEC leaders. Paying attention to the language used by AHEC leaders at the 2024 and 2023 'Aha Pae'āina (naming the Papa Makua position as Conference Minister) two models of embodying self-determination were placed on the table:
 1. AHEC becoming a sister Conference in the UCC
 2. The Heartland Conference Association Design: in this Conference the associations have their own employees, collect OCWM, and perform many of the duties carried by conference offices. The Conference role is resourcing across the associations.
- At the November 2024 Council Meeting, AHEC reported it was not interested in the independent-conference design but was seeking enhanced self-determination. AHEC Luna Ho'omalua was asked to address the AHEC Board

to determine what self-determination means to them. I, as Conference Minister, was asked to bring in the logistic designs of the Heartland Conference Associations.

- At the February 2025 Council meeting the Luna Ho'omalua reported that the AHEC Board did not want to define self-determination. I, as Conference Minister, brought a report on the Heartland Conference Associations. The Luna Ho'omalua was asked to take the report to the AHEC Board for further discussion.
- At the May 2025 Council meeting AHEC did not have a representative present. The Luna Ho'omalua confirmed he could not be there, and unfortunately a misunderstanding of starting time prevented a second representative from attending. There is a question as to whether the conversation remains ongoing at this time.

Looking Ahead to 2026

- **Association Structures:**

Like many associations across the UCC, some associations in the HCUC are straining under structures designed for a past era of church engagement and volunteerism. The time has come for a conversation about future association structure and purposes.

- **Faith Forward Capital Campaign Public Phase:**

Approaching churches and the fuller HUC membership

- **Faith Formation:**

The Pacific School of Religion Certificate program in Theological Education for Leadership (CTEL) is being retooled and redrafted for church cohorts, now titled Congregational Renewal Cohorts. The objective of this new offering is to support congregations by encouraging adaptive leadership and strategic innovation as participants develop a project that supports long-term sustainability and community impact. PSR President, Dr. David Vásquez-Levy will be present at the 'Aha and will host a mealtime table conversation on this development. This program is still open to individuals as the former CTET program was.

Mahalo Nui Loa

It is an honor to labor in the Lord's business with such astute and loving co-laborers as is this Council. Your wisdom and passion remain guiding lights as we all seek the future God calls us to.

In Christ's peace and hope,

Rev. Dr. David K. Popham

Conference Minister,
Hawai'i Conference of the United Church of Christ



**State Council of
Hawaiian Congregational Churches
(SCHCC)**

**Annual Meeting
Kapa`a First Hawaiian Church
June 12, 2025**

President/Vice President's Report

Aloha SCHCC Ohana,

We are excited to gather for the `Aha Iki this year on the beautiful island of Kauai and once again, to meet in person. We would like to extend a warm mahalo to the Kapa`a First Hawaiian Church for providing space to meet for the SCHCC annual `Aha Iki meeting.

It would be remiss if I did not mention that Sharon Matsuyama, the SCHCC President and Boyd Matsuyama, the SCHCC Advisor are not with us this year due to illness. We, however, send our warmest aloha and best wishes for healing and peace to them.

The SCHCC churches have been busy working hard within their faith communities and wider communities with feeding/food distribution programs, youth programs/retreats, music classes/events, Bible studies, a men's ministry program, family fun fellowship time, kupuna workshops and much more. Please take the time to review the individual island reports for the incredible work churches are doing in their corner of God's Kingdom.

We congratulate and mahalo the Island Council Presidents for their dedication in following up with the churches and staying connected with the churches while offering support and guidance.

A big mahalo to all the Officers, Board Members, Partnership Members, and regular guest who participate in SCHCC meetings and programs.

This past fiscal year, the SCHCC was busy and involved in projects funded by the KOKUA MAU programs, which helped several Hawaiian Churches across the State of Hawaii in the Hawaii Conference UCC.

They included the following:

Repair and Maintenance of six Small Membership Hawaiian Churches:

- Liliuokalani Protestant Church, O`ahu-Septic tank installation
- Wai`oli Hui `Ia Church, Kauai-Septic tank installation
- Opihikao Congregational Church, Hawaii Island-Termite treatment
- Kalapana Maunakea Congregational Church, Hawaii Island-Termite treatment
- Kalaikamanu Hou Congregational Church, Molokai-Termite treatment
- Kapa`a First Hawaiian Church, Kauai-Repairs and painting the church and hall

Mahalo to the Hawaii Conference Foundation for providing funds for this program.

Richard Wong Endowment:

- Ka Hana o Ke Akua Church, O`ahu-Repair and painting a food storage trailer for food distribution.

Katherine and Clay Wery Fund:

- Blue Christmas Service and dinner held at Kaumakapili Church on December 21, 2024, for the Institute of Human Services (IHS) community residents.

In addition, the Executive Board and Board of Directors approved the following:

- Newly created **Endowment Policy**
- **Safe Conduct Policy**-submitted to the Insurance Board
- **Finance Policy**-submitted to the Insurance Board

Finally, the history of the SCHCC is shared below. This important information will continue to be shared in quarterly and annual reports, so that we can appreciate and be knowledgeable about why of the State Council of Hawaiian Congregational Churches exists.

About Us: The State Council of Hawaiian Congregational Churches (SCHCC) traces its roots back to the 1948 'Aha Pae'aina of the Hawaiian Evangelical Association (the precursor to today's Hawai'i Conference of the United Church of Christ. The State Council was set up to provide leadership for Hawaiian churches, promote their work, and to nurture fellowship.

The State Council of Hawaiian Congregational Churches was formally recognized at the 1952 'Aha Pae'aina. It continues today with approximately forty-four member churches working together to keep alive the legacy and traditions of the native Hawaiian churches out of a sincere love for the Hawaiian churches and our Lord Jesus Christ!

As representatives and supporters of our respective churches, organizations and each other let us keep moving forward together, in unity, with faith, trust and love.

Mahalo and God's blessings,

Lorna Motas

Lorna Motas-Acting President & Vice President

cc: SCHCC Board of Directors



*Hawaii Conference United Church of Christ
203rd 'Aha Pae'aina*

*State Council of Hawaiian Congregational Churches
Aha Iki – Kapaa First Hawaiian Church*

June 12, 2025
Advisor's Report

Aloha Kakou,

Congratulations to our Executive Committee and Board of Directors for a very productive year. As volunteers, we worked diligently to accomplish our task.

- Our 501c3 got approved by the IRS on August 5, 2024, retroactive to January 23, 2024.
- On February 12, 2024, the State of Hawaii gave a conditional approval pending our 501c3. With our 501c3 passing, the State of Hawaii exempted our G.E.T. to October 15, 2012.
- Insurance Board (IB) required a Safe Prevention policy and Financial policy to augment the Sexual Misconduct Liability (SML) coverage. Policies were submitted on December 27, 2024.
- Endowment Policy drafted by Matt Wagner received on October 1, 2024, and approved by the Board of Directors on January 25, 2025, meeting.
- An Endowment Committee formed to oversee Endowments, per policy.

To our Island Council Presidents / Representatives and Partner, Haunani Pacheco – **Kauai**, Joanne Kishimori / Wendy Garcia – **Oahu**, Uluwehi Sai – **Molokai Topside**, Aileen Trout – **Maui**, Clement Malani Jr – **East Hawaii**, Rollin Rabara – **West Hawaii**, David Popham – **Conference Minister**, Toni Bissen – **Pu'a Foundation**.

To our Executive Committee; Sharon Matsuyama – **President**, Lorna Motas – **Vice President**, Keoki Kiwaha – **Secretary**, Frank Mulec – **Treasurer**, and Boyd Matsuyama – **Advisor**.

Mahalo to our Officers and Directors for your leadership and unending support of the SCHCC.

The SCHCC leadership continues to Advocate for what is in the best interest of all Hawaiian Churches of the Hawaii Conference United Church of Christ.

In His Service,

Boyd Matsuyama

Boyd Matsuyama – Advisor

**State Council of Hawaiian Congregational Churches
(SCHCC)**

**Repair and Maintenance of Small Membership Hawaiian Churches (R &M)
Annual Report
`Aha `Iki-June 12, 2025**

Aloha SCHCC Members,

We would like to extend a warm mahalo to the Kapa`a First Hawaiian Church for co-hosting the `Aha Pae`aina this year and providing space for the SCHCC `Aha `Iki meeting.

This 2025 fiscal year, the SCHCC received additional funding from the Hawaii Conference Foundation (HCF) to support projects due to costly septic tanks installation in 2024. We are grateful for the contributions that the HCF makes to support the upkeep and maintenance of the small Hawaiian Churches in the HCUC.

Below is a summary of the projects that are outstanding and currently in progress.

OUTSTANDING PROJECT FROM 2018:

- **Helani Congregational Church, Hawaii Island**-The church has materials to start the project to repair the south side chapel wall. The repair work is being done by Ahia Contracting Company. The church members are in the process of finding a location to conduct Sunday services away from the chapel.

PROJECTS FROM FISCAL 2024:

- **Liliuokalani Protestant Church, O`ahu**-Septic tank installation-The church moderator, John Hirota reports that materials to start the project are currently on site and work began in April.
- **Wai`oli Hui `Ia Church, Kauai**-Septic tank installation-The church completed their project and photos, and final report were provided.

CURRENT PROJECTS FOR FISCAL 2025:

- **Opihikao Congregational Church, Hawaii Island**-Completed their termite treatment project in April and will be submitting photos and a final report.
- **Kalapana Maunakea Congregational Church, Hawaii Island**-Termite treatment project. No report was submitted. The church received \$7,133.00 in August 2024.
- **Kapa`a First Hawaiian Church, Kauai**-The church was in the process of repairs and painting the church/hall at the time of this report.

- **Kalaiakamanu Hou Congregational Church, Molokai**-The church received \$5,745.00 in March 2025 for a termite treatment project. Their application was approved at the January 25, 2025, SCHCC BOD meeting. No report submitted.

Mahalo for your commitment to serve and maintain your places of worship. May God continue to bless your churches as you build God's faith communities.

Mahalo and God's blessings,

Lorna Motas

Lorna Motas-Acting President & Vice President

cc: Kahu Barry Mick
Kahu Debbie Wong-Yuen
Boyd Matsuyama-Advisor

Kahu Richard W. Wong Endowment Fund
Report for 2025
June 12, 2025

On June 25, 1990, Kahu Richard W. Wong established the “KAHU RICHARD W WONG ENDOWMENT FUND “to help Hawaiian churches for their:

- educational,
- mission,
- scholarship,
- evangelistic,
- personnel,
- and building needs.*”

“Grants are **NOT** to be given to build, maintain, or renovate *income producing facilities*.”

The Endowment Fund, a Restricted Fund, is managed by the Hawaii Conference Foundation (HCF) for the State Council of Hawaiian Congregational Churches (SCHCC).

Based on the fund balance of June 30, 2024, **\$21,887.90** was available for outreach services.

Ka Hana O Ke Akua, from the Wai`anae area of O`ahu, submitted an application. Sun damage, salt air, and rodents deteriorated the trailer, which houses the food and hygiene products for their outreach program. In partnership with the Hawaii Foodbank, church volunteers and volunteers from a neighboring church prepare 100 bags of food, on a monthly basis. The repair of the trailer will keep rain and rodents from entering the trailer.

Total Project Cost is \$13,500

Requested cost for the repair is **\$12,200**

Paint and labor, provided by church members, is \$1,300

The Committee always asks the question: *Will the church's mission fail if this request is denied?*

The Board of Directors of State Council approved the award of \$12,200 to Ka Hana O Ke Akua Church. It is anticipated that the repairs will be completed by August 2025.

Kahu Richard W Wong recognized that our small Hawaiian churches might need assistance. With humility, we honor Kahu Wong in providing for the needs of our churches.

- Chairperson Aileen Trout, Lahuioikalani Ka'anapali Congregational Church
- Haunani Pacheco, Wai`oli Hui`ia Church
- Boyd Matsuyama, Puka'ana Congregational Church



STATE COUNCIL OF HAWAIIAN CONGREGATIONAL CHURCHES
P.O. BOX 407
HOLUALOA, HAWAII 96725-0407

William Kahuakai Keliihoomalu Scholarship Fund
(State Council of Hawaiian Congregational Churches)
Sharon Matsuyama, Chairperson (808) - 936-1385
c/o Hawaii Conference United Church of Christ
700 Bishop Street, Suite 825 Honolulu, Hawaii 96813

SCHCC Annual Meeting
June 12, 2025

Aloha e na hoahanau me na hoaloha,

The deadline for applying for funding through the William Kahuakai Keliihoomalu Scholarship Fund is October 15, of each year. Although it's been quite some time since requests for funding have been received, interested individuals are encouraged to learn about this scholarship fund on the SCHCC website by logging on to www.hcucc.org then clicking on Affiliate Organizations.

The "William Kahuakai Keliihoomalu Scholarship Fund" was established as a memorial Scholarship in 1979, following the passing of Licentiate Kahu, William K. Keliihoomalu. The fund was started with a monetary gift of \$25.00 by Mrs. Ada Larrison, a friend of the family, and continued growing with support from members of the Keliihoomalu 'Ohana, Kalapana Maunakea Congregational Church, and many friends. Mrs. Larrison requested that this gift be placed in a Custodial Account with the Hawaii Conference Foundation, for the purpose of providing financial aid for seminary, postgraduate and continuing education expenses.

When the fund grew to the amount of \$500.00, the State Council of Hawaiian Congregational Churches (SCHCC) was appointed Custodian of this Scholarship fund, by Kahu Richard Kamanu. The State Council of Hawaiian Congregational Churches turned the funds over to the Hawaii Conference Foundation to be invested. An amount of \$5,000.00 was set, as the starting goal, for using the earned interest income, towards the granting of the scholarship fund, for the purpose stated.

The Keliihoomalu Ohana have been asked to review the current policy of the Scholarship Fund, then have discussion on the possibility of revising the policy, purpose, and guidelines.

If there are any questions, contact the Executive Committee/Endowment Committee.

In His Service,

Boyd Matsuyama for Sharon Matsuyama

Sharon Matsuyama
Chairperson - William Kahuakai Keliihoomalu Scholarship

**State Council of Hawaiian Congregational Churches
(SCHCC)**

KATHERINE & CLAY WERY FUND

203rd 'Aha Pae'aina
'Aha Iki - Kapaa First Hawaiian Church

Annual Meeting
June 12, 2025

Aloha Kakou,

The HCUCC was one of the beneficiaries of the estate of Katherine Wery and established the Katherine & Clay Wery Fund for Hawaiian Churches to be administered by the SCHCC.

In July 2016, Dr. Naleen Andrade, hanai daughter of Katherine Hanley Wery, met with the SCHCC Executive Committee to discuss funding, benefiting small rural Hawaiian churches. From this meeting, guidelines and procedures of the Wery fund were established.

Funding was approved for \$2,000.00 to hold a "Blue Christmas" ecumenical and memorial service on December 21, 2024. by the Oahu Council. This event was hosted by Kaumakapili Church with a Worship Service by various Kahu's, and dinner to follow.

Boyd Matsuyama

Boyd Matsuyama

Chairperson, Katherine & Clay Wery Fund

Kaua'i Council of Hawaiian Congregational Churches (KCHCC)
President's Annual Report
May 10, 2025

Member Churches:

Hanapepe Hawaiian Congregational Church
Kapa'a First Hawaiian Church
Koolauhuiia Protestant Church
Ka 'Ohana Ni'ihau Church
Wai'oli Hui'ia Church
Waimea UCC

Officers:

President:	Haunani Pacheco	Wai'oli Hui'ia
Vice President:	Linda Kaauwai-Iwamoto	Kapa'a First Hawaiian
Secretary:	Phoebe Eng	Waimea UCC
Treasurer:	Naomi Yokotake	Wai'oli Hui'ia
Advisor:	Pastor Olaf Hoeckmann-Percival	Waimea UCC

It has been my honor to serve as the President of the Kaua'i Council of Hawaiian Congregational Churches. We met 5 times this past fiscal year and obtaining a quorum was never a problem. Unfortunately, communications with Ka 'Ohana Ni'ihau Church has not been successful by email or snail mail. We need to do better in reaching out to them.

All our churches have had their ongoing struggles with the maintenance of their aging buildings but with grants, Waimea UCC and Kapa'a First Hawaiian have been able to repair their buildings. Wai'oli Hui'ia Church was able to convert the cesspool for the office and parsonage to a septic system.

Hanapepe Hawaiian Congregational Church and Koolauhuiia Protestant Church have managed to continue their services every Sunday by having pulpit supply ministers or members in discernment. Their membership is small, but they continue to serve their communities.

Wai'oli Hui'ia Church is in search of an Interim Minister after their Transitional Minister left in February. Alpha Goto has returned to assist with filling the pulpit and helping them through the process. Rev. Jonathan Roach and Rev. Cheri Dennis are also assisting in finding an interim.

This year our small Hawaiian churches have been busy with community outreach programs. Our churches have had events such as, Mahealani Moon Kanikapila , Back to School Backpack Bingo, Youth Retreat in Kokee, and rummage sales. More detailed reports for each church has been submitted to the Kaua'i Association United Church of Christ.

The biggest breakthrough for our churches without ordained or licensed ministers is that the Church of Ministry (COM) authorized lay people and members in discernment to administer Communion provided they are trained. This is welcoming news as our churches sometimes find it difficult to have an ordained/licensed ministers administer communion.

Attrition continues to be a problem in all our churches although Kahu Olaf saw promise with the youth he had at camp at Waineke. "It only takes a spark to keep the fire going.' We all need new strength, and we trust that the Lord will continue to lift us up on Eagle's Wings.

Respectfully submitted,

Haunani Pacheco
President - KCHCC

OAHU COUNCIL OF HAWAIIAN CONGREGATIONAL CHURCHES
ANNUAL REPORT
AHA IKI - JUNE 2025

The OCHCC is comprised of ten churches:

BERNICE PAUAHI BISHOP MEMORIAL CHAPEL – Chaplain - Kahu Manu Naeole
HAU`ULA CONGREGATIONAL CHURCH – delegate - Bessie Kamakeeaina
KA HANA O KE AHUA - Kahu Brianna Lloyd, delegate – Kahu Brianna Lloyd
KAHIKUONALANI CHURCH – Pastor Rick Hirakawa, delegate Joanne Kishimori
KALIHI MOANALUA CHURCH – guest pastors, delegate Toni Ku-Daniels
KAUMAKAPILI CHURCH – Kahu Heather Barfield, delegate WendyAnn Garcia
KAWAIAHA`O CHURCH – Kahu Kenneth Makuakane, delegate Kaiulani Hess
LILIUOKALANI PROTESTANT CHURCH – guest pastors, delegate Laurie Kauleinamoku
PEARL CITY COMMUNITY CHURCH – guest pastors, delegate Millie Yee
WAIANAE PROTESTANT CHURCH – inactive

EVENTS AND PROGRAMS OF THE OCHCC:

June 2024 – At the annual meeting of the SCHCC , the OCHCC was asked to gather and put out the breakfast items, snacks bento lunches and drinks.

Quarterly meetings were held in person hosted by different churches. Prior to the meetings, the delegates submitted their report by email. I believe that this is one of the strengths and benefits of the SCHCC and OCHCC, the meetings and the sharing of what is going on at the different churches. This gives us the gift of BELONGING to a larger community. I applaud the church delegates for being faithful to sending in their reports. From these written reports and the oral sharing at the meeting, we learn much of what is going on at the other churches.

Meetings and some of programs, events, and concerns:

July, 2024 – unfortunately, no meeting held, but reports were sent in.

October 19, 2024, hosted by Kahikuonalani Church

- Request by Kaumakapili Church for OCHCC to approve an application to the Clay and Katherine Wery Fund for funding of a Blue Christmas Service on December 21, 2024. (this was approved by the SCHCC at their next meeting).
- Request by Ka Hana O Ke Akua to approve an application to the Repair and Maintenance for repair of a storage container for their mission of supplying food along the Waianae coast (see next meeting).
- Status of Oahu Sunday School Association – inactive since Covid.

December 7, 2024 – Special meeting at Kahikuonalani Church to review new application from Ka Hana O Ke Akua. At the SCHCC meeting in October, it was determined that Ka Hana O Ke Akua change their request for repair and maintenance to the Kahu Richard Wong Endowment Fund because theirs is a mission-based request and could be better covered by the Kahu Richard Wong Endowment Fund. The request was approved. (The fund request was granted in January 2025 by the SCHCC.

January 18, 2025, meeting hosted by Pearl City Community Church

- One of the concerns brought up was that once again the SCHCC meeting and the AHEC meeting would be held at the same time again during the Aha Iki. Churches who have one delegate need to choose one of the meetings to attend. (This was later addressed at the SCHCC meeting, that for this year it was already decided, and nothing could be done this year.)

April 13, 2025, held at Kahikuonalani Church (Annual Meeting)

- Elections were held officers elected for the next two years:

President: Wendy Ann Garcia

Vice- President: Laurie Kauleinamoku

Secretary: Kaiulani Hess

Treasurer: Toni Ku-Daniels

Advisor: Joanne Kishimori

The new executive board was installed Kahu Brianna Lloyd.

Submitted by,

Joanne Kishimori, outgoing President- OCHCC

Topside Moloka'i Council Report for 2024

Aloha and greetings from the UCC congregants of Ho'olehua, Kalaiakamanu Hou, Kalua'aha and Waialua Congregational Churches that make up the Topside Moloka'i Council.

Our dedicated church representatives who met on the second Tuesdays of each month at 4 p.m. via ZOOM come from the following churches: Claire Iveson of Kalaiakamanu Hou continued as Chairperson of the Topside Moloka'i Council. Pualani Akaka is from Ho'olehua, Uluwehi Kakaio Sai, from Kalaiakamanu Hou is the Treasurer, Earline Iaea, from Kalua'aha is the Secretary. Louise Laumauna Miguel and Tina He-Lindsey represented Waialua and Kahu Janice Ogoshi made up the rest of the council. The position of Vice Chairperson remained vacant.

Weeks 1 and 5 of the month Kahu Janice conducts worship services at Ho'olehua, Kalaiakamanu Hou and Waialua. Schedule for weeks 2, 3, and 4 was modified for her to have one less Sunday church service for those weeks. This enabled her to spend more fellowship time with church members and not have to rush off to the next church. It also allowed Kahu to be present at each respective church's annual meeting. The congregation and Kahu Janice have adjusted quite well to this modified preaching schedule that started in July 2023.

A Combined Service that involved all four churches on island were held quarterly. Each church planned a special luncheon after the service was over. Ho'olehua was first in March followed by Kalaiakamanu Hou in May, next was Kalua'aha with a Ho'ike in September and last was Waialua in December 2024. Kalua'aha and Waialua also continued to have a "Shared Service" once a quarter at Kalua'aha.

Although there are 6 SPI initiatives that originated in 2018 with HCUCC, the TMC continued to focus only on one initiative. SPI #3: Expansive concept of church: Actively support new or different ways of "being church". Each quarter a report is turned in from each church to the secretary to report activities that are focused on SPI #3.

Uluwehi Sai, a representative from TMC attended meetings of the State Council of Hawaiian Churches via ZOOM on a quarterly basis. Our gratitude and appreciation to Uluwehi Sai for representing and reporting back to TMC.

Kahu Janice does Bible Study sessions on ZOOM throughout the year. The months of February and March had participants focusing on five lessons for Lent. During the summer month of July, a booklet called IN: Experiencing the Depths of Christian Community was used which focused on five different topics for discussion. Four Advent Prayer Gathering lessons (HOPE, PEACE, JOY, and LOVE) were done in December

Some churches like to celebrate certain holidays or events like Kalaiakamanu Hou (Ash Wednesday, (2/14), Maundy Thursday, (3/28), Thanksgiving Eve, (11/27), Good Friday (3/29) Ho'olehua, Easter Resurrection Day (3/31) and Candlelight Service (12/24) Waialua. The number in attendance varied at these services.

The eastside community looked forward to the third Thursday of each month. The Food Bank was open at Waialua Church and many families took this opportunity to pick up fresh produce and canned items to supplement their meals.

Spring 'Aha O Na Mokupuni O Maui, Moloka'i ame Lana'i via ZOOM was held on May 4, 2024, at Iao UCC in person and via ZOOM. Attending virtually were delegates Pualani Akaka from Ho'olehua and Earline Iaea from Kalua'aha. 'Aha Pae'aina was held in person on June 13 -15, 2024 on O'ahu at Central Union Church. Attending State Council mtg. on June 13 were Kahu Janice, delegate Uluwehi Sai (Kalaiaikamanu Hou), Pualani Akaka, Norman Levi, (Ho'olehua), were in attendance. 'Aha Makua, June 14 – 15, with Kahu Janice and delegates attending were Uluwehi Sai (Kalaiaikamanu Hou)) Norman Levi and Pualani Akaka (Ho'olehua) and Maasi and Tina He-Lindsey (Waialua).

The Moloka'i Leadership Group is in its 2nd year of existence under Kahu's guidance. This group evolved from an assignment from Kahu's educational online cohort group. Four women met at least once a month reflecting and sharing their experiences with each other about what they were hearing and learning as they observed God's activity in their churches and in their communities. Many interesting experiences were shared among the group. Their sense of hearing and observing what was going on at church and the community improved as the months went by. Also, a camaraderie was formed among the group.

Once a year event includes the Annual Bazaar on the first Saturday of November for the public. Many hands worked hard to prepare food (lulau plate, Hawaiian delicacies, lots of baked goods, hydroponics raised lettuce. People also donated a wide variety of plants, provided silent auction and rummage items. Another November event was the eighth annual Thanksgiving luncheon for the community chaired by Uluwehi Sai. Lots of food donations, many volunteer cooks and helpers served 500 + plates to the community via drive through and home delivery. We hope that next year we can have a sit-down meal with people, have conversations with each other, sing songs and being in the presence of the Holy Spirit.

We are very blessed that Kahu Janice Ogoshi is our minister. She has provided lots of support, guidance, and assistance to all of the churches in TMC. Her monthly reports to our Council are highly informative. There are a myriad of topics that she shares such as worship plans, Pastoral Care, Association & Conference news, Community involvement, Wider Church activities, meetings, and workshops online provided by HCUCC, or from the "Aha Mokupuni O Maui, Moloka'i ame Lana'i, Minister Retreats and Celebration of Life info for kupuna.

The Topside Moloka'i Council is doing their best to continue representing their congregants and working together to do God's ministry on island.

Blessings,
Earline Iaea
Secretary for Moloka'i Topside Council 2024

State Council of Hawaiian Congregational Churches
Report for July 1, 2024 – June 30, 2025
June 12, 2025

Ka`ahumanu Church

103 South High Street, P.O. Box 1403, Wailuku, Hawaii 96793
Kahu Wayne Higa, (808) 446-4649, Email: kahuwayne@live.com

Worship Service: Sunday Worship – 9 am Bible Study: Wednesday and Thursday 6 pm

We are participating in Joint Worship Services with Wailuku Union and Iao UCC. We are actively seeking out funding resources for some of the sanctuary restoration project. Architectural, structural, and building permit are done. Project manager has been hired, and bids have been received. We just need to raise the money. The cost for the sanctuary restoration project is approximately \$3 million. Kaahumanu Church has sent a letter to churches soliciting koku'a. Our plan is to ask everyone to share the letter with friends and family. Looking for people to connect us with funding sources.

Kahakuloa Hawaiian Protestant Church

No report submitted

Kaulanapueo Congregational Church

27 Door of Faith Road, Haiku, Hawaii 96708
Kahu James Aaron
Contact person - Judy Buettner, (808) 264 6902
Mailing address: 110 Malanani Drive, Kula, Hawaii 96720 (c/o Mahealani Akau)

No worship services are being held at this time.

Kaulanapueo Congregational Church is a small membership church and currently no worship services are available. Even without services, we strive to maintain the property as best as possible. The church is currently dealing with cesspool and septic tank issue that must be taken care of soon, but the cost is high.

Plumbing repairs to the Hale Ai are being done and the church is proceeding to survey the property to outline the boundaries with a fence. The members continue to aloha the property.

Keawala'i Congregational Church UCC

5300 Makena Road, Makena, Hawaii 96753
Office: Andrea, (808) 879-5557, Email: keawalai@hawaii.rr.com
Website: www.keawalai.org
Sunday Worship Service: 10 am

In December 2023 we met and voted for a new Kahu, from New York, who started with us on February 25, 2024. It was a challenging experience for him and for the church. He tried his best to "fit in" with the culture, learn the Hawaiian language which is used in the worship service. He registered for Hawaiian language classes at Maui College and the

instructor is a member at the congregation. It was a struggle for him. After 11 months, he and the church parted ways on January 26, 2025.

While he was with us, we were able to have our weekly bible study on Wednesdays via zoom and continued with our "live streaming" during the worship service. We were able to stay connected with our mainland ohana through these platforms.

Hawaiian language classes were offered to congregation via zoom. It was helpful for those of us that were liturgist and needed to lead the congregation in the Hawaiian portion of the worship service.

Sunday morning worship service attendance goes up and down depending on the time of the year with the highest attendance during January to April. At Christmas and Easter, our front lawn is packed with people; we usually order 500 chairs to accommodate the number of attendees.

A Search Committee is actively searching for a new Kahu. Please keep us in your prayers. *Edie Kapiko*

Keolahou Congregational Church

No report submitted

Olowalu Lanakila Church

No report submitted

Pā'ia Hawaiian Protestant Church

246 Hana Highway, Pā'ia, Hawai'i 96779

Mailing address: P.O. Box 790540, Pā'ia, Hawai'i 96779

Kahu Roy Newton, (808) 244-3885

Church Office: (808) 579-8900, Email: paiahawaiianprotestantchurch@gmail.com

Leni English, Moderator (808) 357-5950, Email: Kulagleni@yahoo.com

Sunday Worship Service: 11 am

Annual Ho'ike was held in November and attended by many sister churches. This event is the highlight of the year.

We honored Prince Kuhio on March 30th ; Ali'i Sunday with the Royal Order of Kamehameha - Kahekili Chapter, Nā Wahine of Kamehameha, and the Ka'ahumanu Society. Dinner was provided for residents at Ka Hale A Ke Ola on March 24th. Celebrating Jesus Resurrection on Easter Sunday, followed by decorating the cross and a Easter egg hunt. Kamehameha Schools Maui Deputation Team to lead worship service on April 27th.

Lāhuiokealani Ka'anapali Congregational Church

3650 Lower Honoapi'ilani Road

Mailing address: P.O. Box 10093, Lahaina, Hawaii 96761

Aileen Trout, Lay leader (808) 987-2536, Email: atrout5525@aol.com

Sunday Worship Service: 10 am

Lāhuiokealani Ka'anapali Congregational Church is a small local membership church with fifteen members. We are strongly supported during snowbird season from January

thru April when 'ohana comes to visit Maui. Since the August 2023 Lahaina fire, the Methodists, Tongan Methodists, King's Cathedral Filipino, and King's Cathedral Tongans used the church. It is a joy to share the sanctuary with other churches. The pianist returned to Maui in April.

Waihe'e Protestant Church

No report submitted

Waiola Church

Kahu Anela Rosa

535 Waihe'e Street

Mailing address: P. O. Box 455, Lahaina, Hawaii 96761

Phone: (808) 264-1553, Email: info@waiolachurch.org

This past year has been one of deep resilience, spiritual renewal, and steadfast hope for Waiola Church and our 'ohana. As we reflect on the time from June 2024 through May 2025, we hold firm to our faith and purpose as we continue the journey of rebuilding — not only our physical sanctuary but our spirit as a congregation.

In the wake of the August 2023 wildfire that devastated Lahaina, Waiola Church remains a beacon of faith, perseverance, and aloha. Over the past year, we have worked closely with FEMA, HiEMA, the County of Maui, and community partners to lay the groundwork for our physical restoration. We formed the Rebuild Waiola Committee and are currently in the planning stages, having recently reviewed proposals for project management and restoration. Our team is committed to honoring the cultural and historical legacy of Waiola as the oldest Hawaiian church and the final resting place of ali'i.

On August 8, 2024, we held a special remembrance bell ringing ceremony, in remembrance of those souls lost in the Lahaina Wildfire. The bell rang the first time since the fire. That day it rang 102 times.

Despite the loss of our sanctuary, our worship life has continued strong. On April 6, 2025, we held our first service back at Waiola grounds. We have held monthly informal services on Communion Sunday outdoors on our church grounds since then, gathering faithfully under tents and trees. These services have become powerful testaments to our endurance and faith, enriched by the sounds of birds, the breeze through coconut palms, and the continued presence of the Spirit among us. Our Outreach Committee has kept members connected with phone calls, online zoom prayer and support sessions and events.

Me ke aloha o ke Akua,

Anastasia Arao-Tagayuna, Moderator

**West Hawaii Council of Hawaiian Congregational Churches
(WHCHCC)**

Annual Report for State Council of Hawaiian Congregational Churches
June 12, 2025

Helani Church:

Pulpit still being supplied by members and guest speakers and Kahu, and attendance is still trending upward. Southside Chapel wall project has unfortunately hit another roadblock as we now need to relocate our services to another safe and viable location on property. Working with members on a temporary solution and hope to start project shortly after. Target date is late May, God willing. Also held our Helani Church Youth Camp with our Norwegian Christian College Ohana with a 100 plus participants, and all funding provided by the Norwegian contingency for supplies, food and beverage and logistics. This has been an awesome partnership for the past 4 years. Also started our first Helani Church Men's Ministry in February and group has been meeting every Thursday's in the evening. Also more recently Pastor Paul Childers who has been a member of Helani Church for 10 years and is the Campus Director at University of the Nations (YWAM) recently received his lay minister status to help us in the area of leading our Holy Communion services, until such time we can call a part-time Kahu which we are currently in the process of doing.

Kahikolu Church:

Informed by Kahu Naleen Andrade at our WHCHCC Quarterly meeting that as of 04-26-25 she will be resigning her licensed ministry from HIA, and relinquishing her duties as Kahu for Kahikolu Congregational Church. This was as result of the long lasting litigation which was settled on 04-06-25 by membership vote by where Kahu Bobby Macomber is now the interim Kahu of Kahikolu Congregational Church after a 42 to 41 membership vote was conducted. Per the litigation settlement both congregations would now be one and lead by Kahu Macomber. Unfortunately Macomber and his followers are resistant to being a member church of the HCUCS thereby making it a little more challenging. The hope is that with the combination of memberships from both sides a resolution can be achieved. So it is with great sadness that we no longer will have Kahikolu Congregational Church as a member to HCUCS, HIA, and WHCHCC. We will continue to pray for all parties involved and trust that God will shine his true light and glory through it all.

Kauaha'ao Church

Worship continues at 10:00 every Sunday; and Kahu Debbie Wong Yuen has returned as Kahu of Kauaha'ao Congregational Church as of 01-05-25. Also a guest Kahu is still be scheduled at least once a month. Also Kahu Wong Yuen has been instituting new ways of worship by scheduling a Family Devotional Sunday and on months with a fifth Sunday a Family Fun Fellowship is scheduled, where Bible and Search and Call games are part of the fun. Community Outreach continues with "The Book Shack" non-profit group selling new and used books, and Narcotics & Alcohol Anonymous group using church as gathering place for their meetings. Celebration of Life Service held for Moderator Dave Williams on 11-02-24. Never ending repairs still exist for the sanctuary and hall, and diligent work still continues with members involvement. Please continue

Kauaha'ao Church (Cont'd)

to pray for our Kauaha'ao Ohana, and Kahu Wong Yuen and her husband Walter who have been battling some health issues, but still have been paving the way for God's work to continue at Kauaha'ao.

Pukaana Church

Pulpit still being supplied by Kahu Keoki Kiwaha, with weekly Communion Service being offered. Also members and officers still continue to participate in several events throughout the year, and attendance at weekly services have increased. Kahu Kiwaha and his congregation continue to ask for prayers for Sharon and Boyd Matsuyama, as all of our Kalawina Churches are aware of the Sharon's current health status and as she goes through her long road to rehabilitation, and as we all would expect Boyd is doing everything in his power to ensure that she is supported during this recovery process. WE know that God is the ultimate physician and we will continue to seek him to help heal Sharon...

Hau'oli Kamana'o Church

Services still being held at 11:00am every Sunday. Pulpit still being supplied by Kahu Mahina Kaupiko and Members with Communion Service being held on every First Sunday. We were informed by Kaimi Kaupiko at our WHCHCC Quarterly meeting that Kahu Mahina has unfortunately experienced health challenges that has limited his service, and asked for prayers for his Brother. They are continuing to conduct services with the current available Ohana to supply their pulpit. Members also participated in several events in 2024-25 and their youth group continues to shine God's light in the Miloli'i Community and around the Big Island. Please pray for Kahu Mahina's healing, and also his Ohana, and that God be there to guide all the Doctors and Nurses that will be a part of his journey to full recovery.

SUMMARY

Overall the past year for our WHCHCC participating churches has been fruitful, but yet has faced several challenges along the way. The loss of Kahikolu Church and Kona Lanakila Church in our WHCHCC, HIA and HCUCC Ohanas are just two of the more highlighted challenges we faced. Some of the other challenges were related to the health of two of our leaders of our churches, in Sharon Matsuyama and Kahu Mahina Kaupiko, both of their prognosis's appear to be positive and we'll continue to pray for both of them as they continue to heal and rehabilitate. Our WHCHCC Board also voted unanimously for Alicia Ilikea Kam to serve on our Board as Vice President. Alicia is a member at Helani Church and has represented me at two HCUCC State Board meetings both in person and on Zoom. Please continue to pray for our WHCHCC Board and all of our participating churches as we "Holomua" through 2025 & 2026.

Submitted by:

Rollin Rabara
Vice President WHCHCC

STATE COUNCIL OF HAWAIIAN CONGREGATIONAL CHURCHES
REPORT OF THE EAST HAWAI'I COUNCIL OF HAWAIIAN CONGREGATIONAL CHURCHES

Annual Meeting
June 12, 2025

Aloha Na Hoahānau,

The East Hawai'i Council Member Churches include:

Haili Congregational Church / Kūhiō Chapel
Kalapana Maunakea First Hawaiian Cong. Church
Laupāhoehoe Congregational Church

Ola'a First Hawaiian Church
'Opihikao Congregational Church
Pu'ula United Church of Christ

The Officers are: Frank J. Mulec, President;
Margaret L. Kamanu, Secretary;
Judith Bailey, Auditor

Clement M. Malani, Jr., Vice President;
Elizabeth J. Salfen, Treasurer and

The East Hawai'i Council meets quarterly, usually on the first Saturday of July, October, January, and April. It continues to be a challenge to have a quorum. SCHCC materials are distributed from the previous BOD meetings. Our next meeting is scheduled for Saturday, July 5, 2025, at Kūhiō Chapel, 09:00 am.

Haili Cong. Church/ Kuhio Chapel, Kuhio Chapel doors remain closed for worship service. Continue using the facilities on Wednesday afternoon for Bible Release Time, evenings on Wednesday and Thursday, Marchaltese, and Fridays for Christian Endeavor. In the Haili Church sanctuary at 8:30 am, spiritual growth with Kaina Waiau, 10 am worship service, and multi-purpose room, 10 am Sunday School. Haili Church Hō'ike was held on Saturday, March 8, 2025. Haili's building repair in progress.
Trusting Jesus, Cynthia Akimseu

Kalapana Maunakea First Hawaiian Cong. Church, Kahu Michael Warren continues to lead our church and shepherd our congregation. Christmas Candle Lighting service was broadcast live on our Facebook page. 'Aha O Nā Kahu Training Course was held at Kalapana Maunakea Church, January 9-10, 2025. There was a shortfall for the termite treatment of our sanctuary and meeting hall due to the time lapse between the quoted price and receiving the grant.
Mahalo no ke Akua, Loke Kamanu

Laupāhoehoe Cong. Church, Church begins every Sunday morning with Christian Endeavor at 09:30 am, Sunday School at 10, followed by Worship Service at 11 with Kahu Vira, then potluck lunch in our social hall. Attended all AHEC functions and was involved in numerous community food distributions. Continue to care for the Pōhakupuka Church graveyard in Ninole, for the churchyard in Laupāhoehoe, and the ohana graveyard down at Laupāhoehoe Point.
Mahalo Ke Akua, Russell Paio

Ola'a First Hawaiian Church, Worship service is held each Sunday at 10:00 a.m. "Devotional Time" takes place prior to service each Sunday. A Christmas Eve service was held at 5:30 p.m. on December 24th. Ola'a's monthly feeding program for the community is ongoing with Kalei Tong, Moderator and as the leader of the group. Lunch is provided monthly at the Kurtistown Park for the community.

Representative, Judith Bailey

'Opihikao Cong. Church, Worship Service continues on the first and third Sundays of each month at 11:00 am. Sunday School has been very slow in starting up. Our repair work is still ongoing to our Social Hall and Kitchen area, and the building still unable to be used, however we see the positive effects of the ground termite treatment to include the termite treatment by tenting of the Social Hall/Kitchen and Hale Hiamoe/(Hale Aina) completed on March 7th. Termite Treatment by tenting of our Sanctuary was completed on April 17, 2025

Pu'ula UCC, This year began with our Annual 'Aha Mele on January 11, 2025 which included the Service of Recognition and Installation for Diane Hultman. Pu'ula became a member of the Association of Hawaiian Evangelical Churches. Pu'ula continues to have Sunday service followed by lunch. The average attendance is 15 people. We have new families attending regularly. The Recovery Center has meetings 6 days a week. The meetings are growing and several of their members attend church and have helped with some repairs to the church building. During the last few months, the entire outside and inside, and roof of the church building, and social hall have been painted.

Mahalo Ke Akua,

Frank J. Mulec

Frank J. Mulec, President



MEMO:

TO: State Council of Hawaiian Congregational Churches Board of Directors
FROM: Toni Bissen, Pū'ā Foundation
DATE: May 6, 2025
RE: Annual Report to SCHCC

Aloha Kākou –

Lots going on at the Pū'ā Foundation, mahalo for the opportunity to share, last time I submitted a report was for the SCHCC board meeting – 4/26/25. This is the annual report submitted to SCHCC covering an overview of Pū'ā Foundation and our programmatic efforts.

Pū'ā Foundation - Who We Are, What We Do & Why:

Pū'ā Foundation is a 501(c)(3) non-profit organization that drives 'Trauma to Transformation' programs for justice-involved women, girls, and their families, especially Hawaiians, and we are proud stewards of the Punahoa Heritage Forest (PHF). With the aim of building strong kids, families and communities, working toward community and individual healing and well-being, we connect resources to need through community organizing, capacity building and training. We were created out of the apology, redress, and reconciliation initiative of the UCC for its complicity involving the 1893 overthrow of Queen Liliuokalani and the Hawaiian Constitutional Monarchy.

Our **vision** is through pū'ā, the process of feeding, nourishing, and strengthening, there will be the emergence of enlightened communities and society. To help in the passing from one to another generation the nourishment of our ancestral dignity from which we revitalize our national consciousness. Through such acts of humanity, new life springs forth. So shall it be with the Hawaiian people. Our **mission** is to actively engage, facilitate and serve communities and their efforts to build a resilient society and improve upon their quality of life through healing and reconciliation efforts that address consequences of the 1893 overthrow.

We consider the over-representation of Native Hawaiians in the criminal justice system as an example of such a consequence. We believe there is a correlation of imprisonment rates and historical, community and individual trauma and thus a primary focus is to support families affected by trauma and incarceration, especially justice-involved women. **Our tagline is, "Trauma to Transformation, Incarceration to Independence."**

Our two main 'Trauma to Transformation' program areas are:

- 1) the Mana Wahine initiatives, and**
- 2) the Punahoa Heritage Forest initiative**

Both are putting into action caring for the land and caring for the people efforts, which in the Hawaiian language/worldview, is to **mālama 'āina, and mālama kanaka.**

Pū'ā Foundation was featured as part of the Living and Giving Aloha - Baraquio Sisters 2024 TV Special - Dec. 2024.

- See six minute segment on the work of Pu'a Foundation
<https://www.punahoaheritageforest.org/news/living-and-giving-video>



- "The work that we do at the Pū'ā Foundation really focuses around how ancestral knowledge and cultural practices have, in fact, the power and potential to heal trauma," said Bissen, who argues that "trauma" can be experienced by a native forest struggling with a fungal disease.
 - <https://www.hawaiipublicradio.org/local-news/2025-02-12/trump-executive-order-impedes-funding-native-hawaiian-led-climate>



Trump executive order impedes funding for Native Hawaiian-led climate work

Hawai'i Public Radio | By [Savannah Harriman-Pote](#) - Published February 12, 2025 at 12:09 PM HST

1) **Mana Wahine Initiatives - Mālama Kānaka & By the Numbers:**

HOUSING: Transitional Housing program for women exiting prison at the Mercy House.

• **TRANSITIONAL HOUSING PROGRAM FOR WOMEN EXITING PRISON**

 <p><u>HOUSING</u>: See Mercy House Video - https://www.youtube.com/watch?v=AWMb5h_VRDE</p>	<p><u>2024 – Mercy House I - Residents</u> Jan to Dec.- there were 4 residents and a house mother</p> <p><u>2024 – Mercy House II - Peer Support Training Center and Office</u></p>
---	--

WELL-BEING: Development of healthy relationships with self and others:

- coordinating Family/Keiki days - Mālama 'Ohana at the Women's Community Correctional Center (WCCC) -
- facilitation Oahu Going Home meetings
- facilitating Pre-Transition and Cultural Healing and Well-Being courses at WCCC, and the Federal Detention Center,
- coordinating WCCC workline 'Aina Work days at the Waimanalo Community Farming project

- **Keiki Day at the Women's Community Correctional Center**

	<u>2024 – Aug. Summer - Keiki Day</u> 13 - WCCC Mothers 23 - Keiki 14 - Caregivers 20 - Volunteers 20 - WCCC Staff/Workline 90 participants
---	--

- **Keiki Day at the Women's Community Correctional Center**

	<u>2024 – Dec. - Christmas - Keiki Day</u> 12 - WCCC Mothers 19 - Keiki 12 - Caregivers 35 - Volunteers 10 - WCCC Staff/Workline 88 participants
---	---

- **Oahu Going Home:Community organizing-public, private & faith-based volunteers**

52- total # of women released from the Women's prison
21 - Max Out - status
31 - Parole - status
25 - total # of women assisted

- **PreTransition & Cultural Healing & Well-being Classes; Waimanalo workdays**

1 - PreTransition courses at Women's prison
1 - PreTransition course at Federal Detention Center
8 - Waimanalo workdays

WORKFORCE DEVELOPMENT AND SERVICES: Vocational and leadership training, and employment for Peer Support Specialists - those with lived experience helping others with similar experiences - such as transitioning from prison, and recovering from substance use challenges.

- **Peer Support Training**

11 - Total Trained
4 - Hilo
7 - Oahu

2) **Punahoa Heritage Forest Initiative**

See Attached Updated Brochure

THE LAND

The Punahoa Heritage Forest has been created and developed by the **Pū‘ā Foundation**, with the **Hawaii Conference Foundation of the United Church of Christ Board of Trustees**. The 2,200 acre property forms an elongated shape with an east-west orientation. It is located west of the Daniel K Inouye Highway on Hawai‘i Island, just a 20-minute drive from Hilo. *There are three parcels - Parcel 4, 11, and 12. In addition, a 1.3 acre off-site agriculture parcel in the Kaumana area is also part of the PHF initiative.*

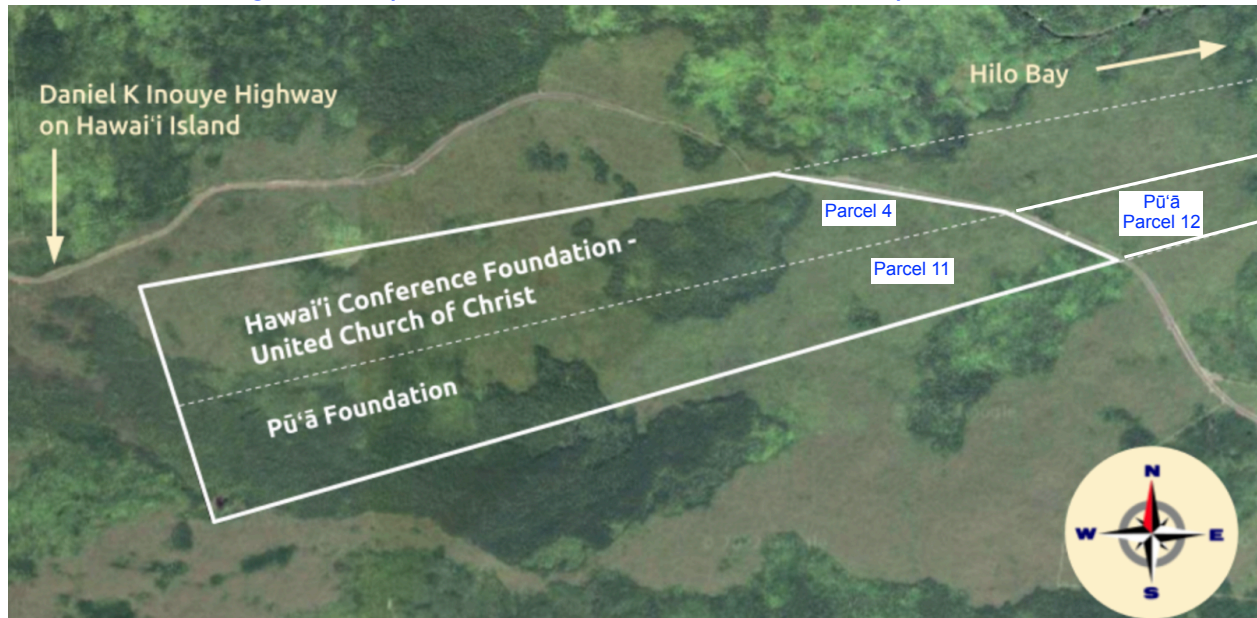

Punahoa Heritage Forest (PHF)

Punahoa Heritage Forest sees a future where people and nature thrive.



FOR MORE INFORMATION

Check out our websites:

- punahoaheritageforest.org
- puafoundation.org

CONTACT US:

- Toni Bissen; 808-221-6656
- toni.bissen@puafoundation.net



PŪ‘Ā FOUNDATION
Empowering Individuals, Families & Communities

*We are a 501c3 non-profit created in 1996. Driving ‘Trauma to Transformation’ programs for justice-involved women girls & their families, especially Hawaiians.
We are proud stewards of the Punahoa Heritage Forest.*





VISION & VISION NARRATIVE

The vision of the PHF is for a forest of world-renown that enables Hawaiians to know, care and connect with their heritage.

MISSION & STRATEGY MAP

The mission of the PHF is to preserve and protect the natural state of the forest. To help it flourish as a place of gathering, rejuvenation and cultural expression for all Hawaiians and for those who embrace Hawaiian culture.

Mission Strategy Map

Preserve and protect the natural state of the forest.

Help it flourish...

... as a place of gathering, rejuvenation and cultural expression...

... for all Hawaiians and for those who embrace Hawaiian culture.

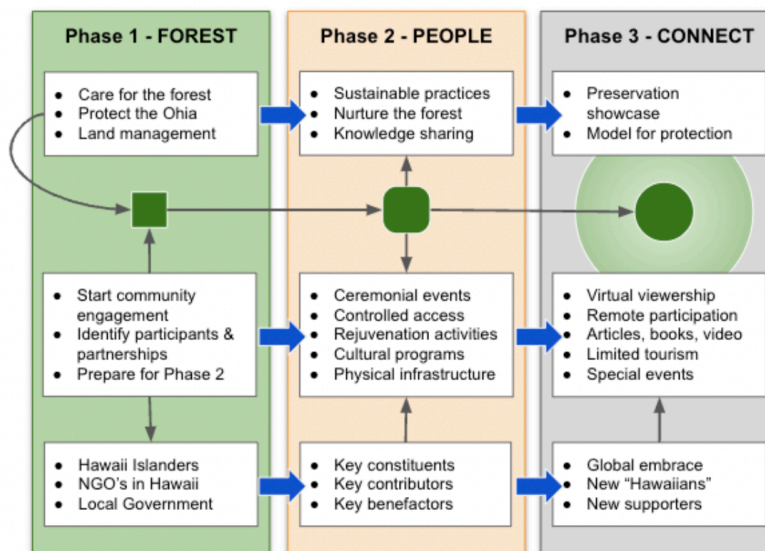

World-renowned forest...



- Stand for something / be meaningful
- Be known locally, but aim for world-renown
- Be more than a place; be a compelling idea

... enables Hawaiians to know, care and connect...



- Know - educate, inform, tell our story
- Care - voice of elders, community engagement
- Connect - physically, emotionally, spiritually

... with their heritage.



- Cultural heritage
- Natural heritage

PHF - Forest Stewardship Plan - Management Units

- Makai Unit - 230 acres (Parcel 12)
- Kipuka Unit - 660 acres (Parcel 4 & 11)
- Mauka 'Ekahi Unit - 258 acres (Parcel 4 & 11)
- Mauka 'Elua Unit - 498 acres (Parcel 4 & 11)
- Mauka 'Ekolu Unit - 567 acres (Parcel 4 & 11)

PHF - Strategies - Weed Control (WC) & Restoration

Weed Control:

1. Vector Sweep & Treatment
2. Project Installation Sweep and Treatment
3. Sweep & Treatment of larger Management Units
4. Guava Biocontrol & Cultural Practices

Restoration:

1. Practitioner Trail Native/Cultural Establishment & Plant
2. Post Herbicide Treatment Planting Native/Cultural as needed
3. Restore Key Native Forest Species across forest as needed
4. Remove Ungulates

PHF - Agricultural Parcel

1. Seedbank
2. Nursery
3. Care Farm
4. Biocultural Learning & Wellness Center

Ahupua'a - Punahoa 2 - Punahoa Heritage Forest Location



PŪ'Ā FOUNDATION
Empowering Individuals, Families & Communities

www.puafoundation.org
www.punahoaheritageforest.org

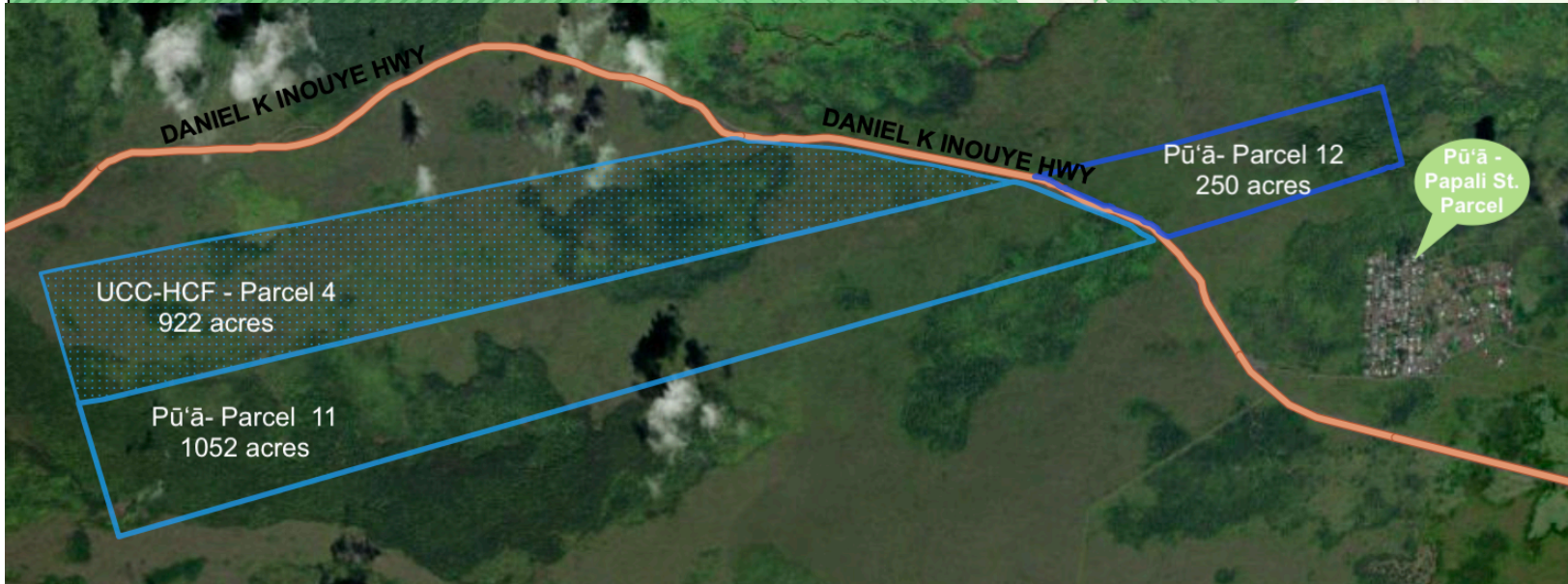
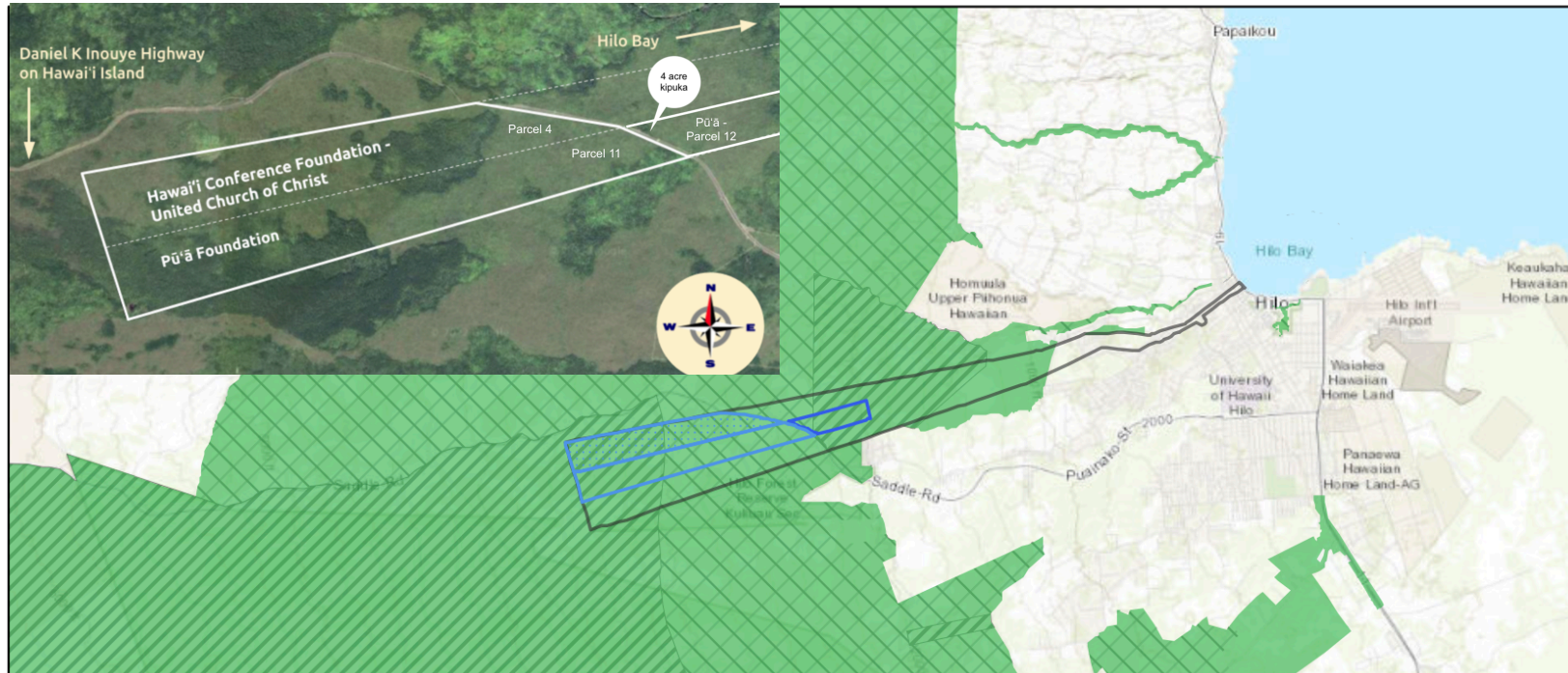

PHF - Agricultural Parcel
Papali St.
Seedbank, Nursery, Care Farm &
Biocultural Learning & Wellness
Center





PHF MANAGEMENT UNITS

PHF - Forest Stewardship Plan - Management Units

- Makai Unit - 230 acres (Parcel 12)
- Kipuka Unit - 660 acres (Parcel 4 & 11)
- Mauka 'Ekahi Unit - 258 acres (Parcel 4 & 11)
- Mauka 'Elua Unit - 498 acres (Parcel 4 & 11)

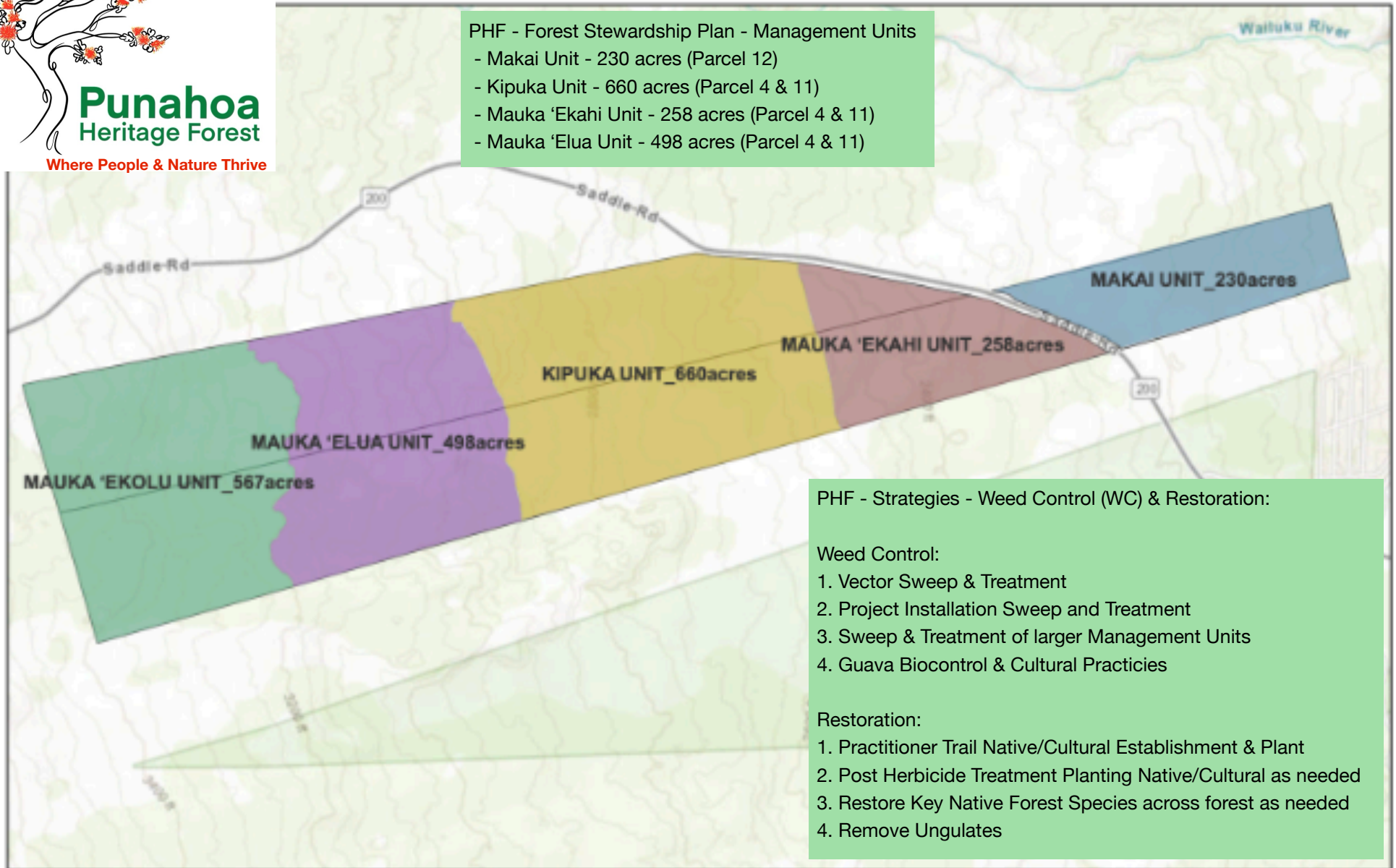

PHF - Strategies - Weed Control (WC) & Restoration:

Weed Control:

1. Vector Sweep & Treatment
2. Project Installation Sweep and Treatment
3. Sweep & Treatment of larger Management Units
4. Guava Biocontrol & Cultural Practices

Restoration:

1. Practitioner Trail Native/Cultural Establishment & Plant
2. Post Herbicide Treatment Planting Native/Cultural as needed
3. Restore Key Native Forest Species across forest as needed
4. Remove Ungulates